

Construction of Chinese Discourse and Narrative System for New Chinese Landscape in the Era of Artificial Intelligence

Yang Sheng

Zhaoqing University, Zhaoqing, Guangdong, China

DOI: <https://doi.org/10.5281/zenodo.14565436>

Published Date: 28-December-2024

Abstract: With the rapid development of artificial intelligence technology, intelligent technologies have been widely applied in landscape design, particularly in the field of New Chinese landscape design. As a product combining tradition and modernity, New Chinese landscape not only inherits the essence of Traditional Chinese landscape but also integrates modern design concepts and technological means. This paper explores the current application of artificial intelligence in landscape design, analyzing its impact on design processes and methods, as well as its potential and advantages in New Chinese landscape design. Meanwhile, this paper also discusses the construction of the Chinese discourse system for New Chinese landscape, including the refinement and application of Traditional Chinese Culture elements, the guidance of Chinese philosophical thought, and the integration and expression of regional characteristics and cultural heritage. Finally, this paper explores the role of artificial intelligence in constructing the narrative system of New Chinese landscape, along with successful case analyses and practical exploration, and provides expectations and suggestions for New Chinese landscape designers.

Keywords: Artificial Intelligence; New Chinese Landscape; Landscape Design; Chinese Discourse; Narrative System.

1. INTRODUCTION

With the rapid development of artificial intelligence technology, intelligent technologies have been widely applied in various fields, especially in landscape design, where artificial intelligence is gradually changing design methods, optimizing design processes, and bringing new creative possibilities. The introduction of intelligent algorithms, machine learning, automated design, and other technologies has made landscape design more efficient and precise, better addressing complex environmental issues. This undoubtedly brings new opportunities and challenges to landscape design.

New Chinese landscape is a modern interpretation of Traditional Chinese landscape, which not only inherits the essence of Traditional Chinese landscape, such as reverence for nature and the harmonious relationship between humans and nature, but also incorporates modern design concepts and technological means. Its main characteristics include modern interpretations of traditional elements, contemporary expressions of cultural symbols, and the organic combination of nature and humanity, reflecting the inheritance and innovation of Chinese culture.

In the context of globalization, establishing a landscape discourse system with Chinese characteristics has become particularly important. Through landscape design to convey Chinese cultural values and philosophical thoughts, it can not only enhance cultural confidence but also demonstrate China's cultural soft power on the international stage.

2. CURRENT APPLICATION OF ARTIFICIAL INTELLIGENCE IN LANDSCAPE DESIGN

In contemporary landscape design, artificial intelligence technology has not only changed traditional design processes but also provided new creative perspectives. As an interdisciplinary tool, artificial intelligence combines data science, ecology, and artistic creativity to inject innovation and functionality into landscape design. To better understand its specific manifestations in design practice, the following will analyze innovative applications of artificial intelligence technology in landscape design through actual cases.

2.1 Innovative Applications of Artificial Intelligence Technology in Landscape Design

Here we will present two cases: *Hortum Machina B* from University College London's School of Architecture, and the AI Mechanical Flower developed by Shanghai Jiao Tong University's Digital Landscape Laboratory.

Hortum Machina B is an experimental project combining robotics, art, and environmental science. This project, designed by architectural and urban design practice Ecologic Studio, explores how urban spaces can create responsive and sustainable environments through the combination of living systems and robotics. This new type of intelligent combination product not only brings visual and tactile impact but also reveals new applications of artificial intelligence in ecological protection and daily life. It can better shape user experience, stimulate our thinking during design and application stages, enhance viewing experience, and strengthen our perception of nature.



Figure 1: Stimuli from the surrounding environment (Figures 1–4 sourced from https://zgt.china.com.cn/v2/content/2023-08/16/content_39120.html)



Figure 2: Connection of the control loop for the robotic ecosystem.

Through in-depth research on plant electrophysiology, we successfully integrated plants' natural "intelligence" with the control loop of an autonomous robotic ecosystem. This innovative combination, both garden and machine, represents a new form of life control, to which we gave the symbolic name *Hortum machina B* (Figure 2).

The AI Mechanical Flower interactive landscape is a high-tech art piece developed by Shanghai Jiao Tong University's Digital Landscape Laboratory. It uses artificial intelligence technology to transform flowers' sensitivity to light in nature into responses to human behavior. Following biomimetic principles in its design and combining distance sensors and visual capture technology, the mechanical flower can sense and respond to human approach and movement. Through integrated motion recognition algorithms, the mechanical flower can dynamically display leaf opening and closing in four interactive modes, creating an intelligent landscape that simulates natural plant behavior. This design not only enhances the interactivity of the landscape but also deepens people's perception of environmental changes.



Figure 3: Design diagram and actual deployment results of the AI Mechanical Flower

2.2 Changes in Landscape Design Processes and Methods Due to Artificial Intelligence

In the field of landscape design, the application of artificial intelligence (AI) is reshaping traditional design processes. Through data-driven site analysis, AI uses Geographic Information Systems (GIS) and other environmental data to provide designers with precise site information, establishing a solid foundation for design. Subsequently, AI automatically generates multiple design schemes based on user input and preferences, significantly improving design efficiency. During the design iteration process, AI assists designers in continuously optimizing solutions to maximize spatial layout and aesthetic effects. Furthermore, AI ensures design accuracy through intelligent construction drawing verification and improves construction efficiency and safety through intelligent construction management monitoring. After construction, AI continues to play a role in subsequent intelligent maintenance, such as real-time monitoring and automatic control through smart irrigation systems. Meanwhile, AI integrates user feedback to make designs more aligned with user needs, enhancing engagement and satisfaction. In promoting sustainability, AI provides decision support, helping make wiser choices in material selection, energy use, and ecological protection, promoting long-term sustainability in landscape design. This series of AI applications not only improves design and construction quality but also brings users richer and more personalized experiences (Figure 4).

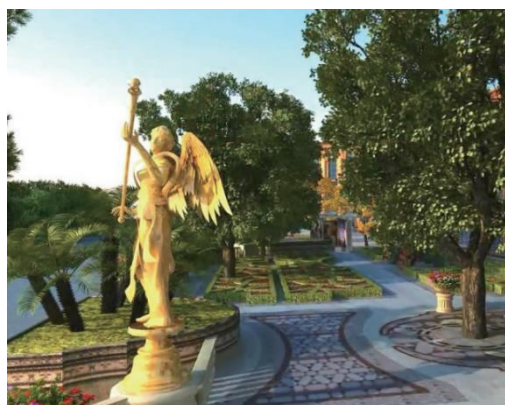

Figure 4: Three-dimensional landscape image generated using AI

2.3 Potential and Advantages of Artificial Intelligence in New Chinese Landscape Design

In the landscape design field, artificial intelligence (AI) is becoming a key tool for enhancing design efficiency, strengthening innovation, and optimizing solutions. AI's simulation and prediction capabilities help designers improve resource utilization efficiency in New Chinese landscape design and achieve continuous optimization of solutions. AI technology also deeply explores and applies Chinese traditional cultural elements, making New Chinese landscape design closer to local cultural characteristics. In terms of human-machine interaction, AI technology greatly enhances visitor engagement and satisfaction through intelligent guidance and tour guide systems and other intelligent interactive experiences. Regarding ecology and sustainability, AI improves the environmental performance of New Chinese landscape through smart irrigation and energy management systems. Meanwhile, the real-time monitoring capability of intelligent monitoring and maintenance systems promptly resolves landscape maintenance issues, improving safety and maintenance efficiency. Additionally, AI demonstrates its powerful computational capabilities when facing complex design challenges such as high-density urban environments. Overall, the application of AI in landscape design has not only improved the quality and efficiency of New Chinese landscape design but also made it more intelligent and sustainable.



Figure 5: Three-dimensional landscape of New Chinese architecture generated using AI. (All images without explicit attribution were created by the author)

3. CONSTRUCTION OF CHINESE DISCOURSE SYSTEM FOR NEW CHINESE LANDSCAPE

The cultural value and design concept innovation of New Chinese landscape design stems from the deep integration of Traditional Chinese Culture and contemporary design trends. As a physical carrier of Chinese culture, New Chinese landscape not only shoulders the mission of inheriting Traditional Chinese Culture but also constructs a unique discourse system with Chinese characteristics in the international context. The following will further explore how traditional cultural elements are refined and applied in New Chinese landscape, demonstrating their enrichment and expansion of design language.

3.1 Refinement and Application of Traditional Cultural Elements in New Chinese Landscape

New Chinese landscape design ingeniously integrates classical garden art with modern design concepts, creating garden spaces with profound cultural heritage and modern aesthetics. In terms of landscaping techniques, New Chinese landscape draws on classical garden techniques such as framing views, blocking views, dividing views, borrowing views, opposing views, filtering views, inserting views, and adding views to guide, organize, and converge sightlines, making landscape space extend directionally to achieve specific landscape effects. Meanwhile, through clever integration with modern landscape elements, it creates landscape spaces that are both richly varied and harmoniously unified, achieving the effect of changing scenes with each step and seeing the big in the small. In color selection, New Chinese landscape primarily uses "national colors" representing Chinese civilization, such as Chinese red, glazed yellow, Great Wall grey, jade white, and Chinese scholar tree green, combined with landscape materials to create landscape spaces that are both sublime, festive, and auspicious, while maintaining tranquility and restraint (Figure 6).



Figure 6: Traditional cultural elements of classical gardens (Painting by Xu Yi; photography by the author)

In the application of Chinese traditional symbols, New Chinese landscape design ingeniously employs elements such as auspicious objects, the Five Elements, the Chinese Zodiac, oracle bone inscriptions, pictographs, and ethnic characteristic patterns through abstract or simplified approaches to reflect the connotations of Traditional Chinese Culture. In plant space creation, New Chinese landscape combines natural and neatly trimmed plants, emphasizing the refinement of natural color tones, possessing a strong Chinese atmosphere (Figure 6).



Figure 7: Examples of modern designs of New Chinese courtyards (Image source: Longfor Group's official website)

In spatial layout, New Chinese landscape design employs techniques such as gradual progression, combination of movement and stillness, contrast between virtual and real, as well as the spatial arrangement principle of "a whole universe in a pot", ingeniously increasing depth perception within limited space to create infinitely rich garden scenes.

In courtyard design, New Chinese courtyards inherit and develop traditional courtyards within the context of modern design and living backgrounds, integrating modern design elements such as combining traditional courtyard constituent elements with new materials and simplifying design elements, which both preserves the charm of traditional courtyards and meets the living needs of modern people. Overall, New Chinese landscape design continuously innovates and breaks through while inheriting and carrying forward Traditional Chinese Culture, displaying unique artistic charm and contemporary spirit (Figure 7).

3.2 Guidance of Chinese Philosophical Thought in New Chinese Landscape Design

New Chinese landscape design is deeply influenced by Chinese philosophical thought, ingeniously integrating traditional concepts with modern design techniques. Taoist philosophy of "unity of heaven and man" is reflected in design through the pursuit of harmony between natural and artificial environments, creating spaces that are both ecological and culturally meaningful. Confucian "doctrine of the mean" is expressed through symmetrical layout, balanced plant configuration, and color matching, reflecting aesthetic principles of balance and moderation. Buddhist Zen thought emphasizes spatial blank space and tranquility. Besides these mainstream thoughts, the absorption and expression of other traditional cultures are also flexibly applied in modern environments. For example, the expression of Tao Yuanming's farming and reading lifestyle and family ethics, the aesthetic recreation of Tang poetry and Song lyrics, and the application of Chinese painting composition all make New Chinese landscape design inherit the tradition of Chinese classical gardens in creating profound artistic conception through elements such as mountains, water, plants, and architecture, making the landscape a dual enjoyment of visual and spiritual experiences.

New Chinese landscape design is not simply copying traditional elements but making modern interpretations and innovative applications of traditional elements based on a profound understanding of Chinese philosophy. This design concept not only inherits the spiritual connotation of Chinese classical gardens but also demonstrates the spirit of innovation with the times.

3.3 Integration and Expression of Regional Characteristics and Cultural Heritage

New Chinese landscape design deeply integrates regional characteristics and rich cultural heritage, creating modern spaces that are both harmonious and meaningful. The design first considers the integration of local natural environment, carefully selecting appropriate plant species and design elements according to local climate, topography, vegetation, and other natural conditions, ensuring the harmonious coexistence of landscape and natural environment. In terms of historical and cultural inheritance, the design focuses on excavating and utilizing local historical stories, traditional arts, local symbols, and other

cultural resources, integrating these cultural elements into the landscape through clever landscape design techniques, allowing history to be passed down.

The reflection of social customs is also an important aspect of design. By understanding and respecting local residents' lifestyles and customs, these social and cultural factors are reflected in public space design, such as Lingnan Tea and Fruit Festival and Lion Dance culture, thereby enhancing the social and cultural aspects of the landscape. The use of local materials not only helps reduce costs but also makes landscape design have unique regional characteristics and sustainability.

The configuration of native plants contributes to ecological balance while showcasing local plant diversity. The use of local colors has strong visual impact and cultural symbolic significance, adding a rich cultural atmosphere to the landscape.

The integration of local arts such as sculpture, painting, and calligraphy adds artistic value and cultural connotation to the landscape. The innovative application of local symbols and patterns allows local-specific cultural elements to find new expression in the landscape.

Overall, New Chinese landscape design successfully transforms regional characteristics and cultural heritage into modern landscape spaces with vitality and appeal through these meticulous integrations and expressions.

4. CONSTRUCTION OF NARRATIVE SYSTEM FOR NEW CHINESE LANDSCAPE

Landscape design is not only an artistic expression of space but also an important form of cultural narrative. In the construction of New Chinese landscape, the narrative system infuses design with emotion and story, conveying regional culture and historical connotations through the construction of multi-layered narrative structures. To further clarify the specific application of narrative systems in landscape design, the following analysis will be conducted in conjunction with related research on narrative theory.

4.1 Application of Narrative Theory in Landscape Design

The application of narrative theory in landscape design has injected storytelling and vitality into traditional spaces. Through the integration of narrative and spatial experience, landscape design becomes not merely static beauty but a dynamic narrative, allowing people to experience the flow of stories and the depth of time as they move through it. As a carrier of culture, landscape inherits local history and culture through narrative methods, transforming the design site into a vivid museum that tells the area's unique historical stories.

The emotional resonance and humanistic care in landscape design make spatial design transcend visual aesthetics, touching people's emotions and establishing emotional connections between people and the environment. The structural design of spatial narrative endows the landscape with clear narrative clues and logic, allowing visitors to follow the narrative's beginning, development, climax, and ending, experiencing a complete journey.

The introduction of the time dimension means landscape design is no longer limited to spatial effects but displays evolving features through seasonal changes and the passage of time. The diverse expression of narrative elements, such as sculptures, installation art, interpretive signs, and terrain changes, work together within the landscape to enhance its narrative quality and artistic value.

4.2 Narrative Themes and Emotional Expression in New Chinese Landscape

New Chinese landscape design skillfully integrates Chinese Traditional Culture and modern aesthetics, displaying unique cultural charm through narrative themes with profound cultural connotations, such as Confucian worldly philosophy and Taoist views of nature. Designers use traditional garden-making techniques combined with modern design language to create emotionally resonant spaces. The narrative quality of spatial layout guides experiencers to feel the stories and emotions contained in the landscape through ordered sequences and rhythms.

The integration of modern technology, such as the clever application of lighting and acoustics, adds atmosphere to narrative scenes, enhancing emotional experience. Meanwhile, New Chinese landscape emphasizes the uniqueness of regional culture, integrating local characteristics and cultural elements into the design, making each landscape work have unique

regional narrative themes. The setup of interactive experiences, such as participatory landscapes and experiential walkways, allows visitors to more deeply experience the emotions and stories conveyed by the landscape.

Finally, New Chinese landscape design also emphasizes the concept of sustainable development, demonstrating respect and protection for the natural environment through measures such as using ecological materials and rational utilization of water resources, cleverly combining tradition with modernity, nature with humanity, and static with dynamic to create modern landscape spaces that are both aesthetically pleasing and meaningful.

4.3 Intelligent Generation of Landscape Narrative Content by Artificial Intelligence

In the field of landscape design, artificial intelligence is bringing revolutionary changes to narrative content generation through its unique data-driven capabilities and advanced algorithms. AI can automatically generate narrative content highly matched with site background and user needs by analyzing geographic, cultural, historical data, as well as user behavior and preferences. This data-driven narrative generation not only enriches the cultural connotation of landscapes but also enables personalized narrative experiences. Using machine learning algorithms, AI can customize unique narrative experiences based on individual users' behaviors and feedback.

In recent years, with the application of increasingly advanced technologies, there has been significant advancement in promoting Chinese culture. The holographic projection at the Hangzhou Asian Games, the digital panoramic three-dimensional imaging technology of the Grand Canal, and the digital torch relay participated by 100 million people all demonstrated China's rapid technological development comprehensively.

In this year's Spring Festival Gala programs, Virtual Production (VP), Extended Reality (XR), Artificial Intelligence (AI), and Augmented Reality (AR) were perfectly integrated, bringing audiences an unprecedented immersive audiovisual feast. For example, at the 2024 Spring Festival Gala's Xi'an branch venue in Shaanxi, AI recreated the poetic Tang Dynasty scene of Chang'an. The interaction between the animated character Li Bai and actor Zhang Ruoyun achieved the first interaction between real person and animation on the Spring Festival Gala stage. In the finale, the scene of Li Bai touring showed the current Xi'an from the poet's perspective, traversing a thousand years, soaring over the Great Tang Never-setting Sun City. This brought the atmosphere to a climax, allowing people to directly experience the charm of traditional culture.

This intelligent narrative generation not only enhances the artistry and interactivity of landscape design but also brings users richer, more personalized experiences. With the continuous development of AI technology, we have reason to believe it will play an increasingly important role in the field of landscape design (Figure 7).



Figure 8: Plan view of New Chinese landscape flower beds generated using AI

4.4 Application of Artificial Intelligence in Enhancing Landscape Narrative Experience

The application of artificial intelligence technology in landscape narrative experience has brought innovative changes to traditional garden art. Personalized experiences use AI to analyze visitor behavior and preferences, customizing unique landscape stories for each visitor, allowing everyone to experience personalized narratives. Interactive narratives utilize sensors and AI algorithms to make landscapes respond to visitors' movements in real-time, providing strongly engaging experiences.

Context-aware content allows AI to adjust narratives according to environmental conditions such as time, weather, and season, ensuring harmony between stories and current contexts. The integration of Augmented Reality (AR) and Virtual Reality (VR) experience technologies further expands narrative boundaries, creating immersive story environments that allow visitors to transcend time and space limitations to experience stories in different contexts.

Intelligent guide systems not only provide location-based personalized interpretation but also enhance educational and guidance functions. Emotional analysis allows AI to identify and respond to visitors' emotions, dynamically adjusting narrative content to provide more thoughtful experiences. AI's dynamic story generation capability creates non-linear and multiple-ending narrative structures based on visitor interaction and feedback, enriching narrative possibilities.

AI's deep learning capabilities enable it to explore site culture and history, providing educationally valuable content. Meanwhile, AI's predictive maintenance and optimization ensure narrative experience continuity and quality. Multimodal interaction creates layered narrative methods by combining visual, auditory, tactile, and other sensory experiences.

Finally, social media integration allows visitors to share their experiences, increasing social interactivity and expanding the influence of landscape narratives. These applications demonstrate how artificial intelligence enhances the personalization, interactivity, and immersion of landscape narratives, providing visitors with unprecedented experiences.



Figure 9: Virtual impression of Li Bai at Xi'an during the Spring Festival Gala, created using AI (Source: <https://baijiahao.baidu.com/s?id=1790871915530386849>, The Voice of China Association for Science and Technology)

4.5 Practical Exploration: New Chinese Landscape Design Practice Incorporating Artificial Intelligence Technology

Designing a New Chinese small courtyard that integrates Guangfu culture requires deep exploration of the cultural characteristics, climate conditions, and historical background of the Guangdong region, especially the Pearl River Delta area.

For this design, the center of the scene can be a classical "wok-ear house" or Guangfu cultural architecture, surrounded by a New Chinese courtyard landscape. In the courtyard, a winding path connects the building complex and a rest pavilion. Tropical plants such as bamboo and banana trees are planted along the path, creating the unique tropical atmosphere of Lingnan. Meanwhile, blue bricks or cobblestones are laid on the path, adding traditional elements and interesting design elements.

The overall scene is dominated by New Chinese style, integrating unique elements of Guangdong Lingnan culture and the essence of traditional art, presenting an aesthetic that is both classically elegant and modern. Such New Chinese landscape not only showcases the cultural charm of the Guangdong region but also provides people with a comfortable and pleasant leisure space.

From the results, using the Midjourney drawing tool can achieve most creative ideas, greatly improving design time and maintaining certain effect stability. However, it shows insufficient representation of specific elements such as wok-ear houses, which could be improved after feeding and learning such images (Figure 10).



Figure 10: New Chinese landscape designed with artificial intelligence

5. EXPECTATIONS AND SUGGESTIONS FOR NEW CHINESE LANDSCAPE DESIGNERS

In the artificial intelligence era, New Chinese landscape designers should master and integrate artificial intelligence technology to enhance design innovation and interactivity while using artificial intelligence for data analysis, such as site analysis and user behavior analysis, to drive design decisions with data and improve design scientificity and precision. Designers should also explore using artificial intelligence to generate landscape narrative content, providing personalized and dynamically changing experiences that allow landscapes to tell richer and more vivid stories. Furthermore, artificial intelligence technology can be used to create interactive landscapes, achieving real-time interaction between landscape and people through sensors and machine learning algorithms; combining virtual reality and augmented reality technologies to design immersive experiences that allow users to deeply experience the cultural connotations of New Chinese landscape; and through emotional analysis, adjust designs based on users' emotional responses to provide more thoughtful experiences. Artificial intelligence can also support intelligent maintenance prediction and optimization of landscapes, improving their sustainability and long-term aesthetics. Designers need to continuously learn new technologies, collaborate with cross-disciplinary teams including data scientists and engineers, explore new applications of artificial intelligence, while paying attention to ethical and sustainability issues to ensure technological applications are harmless to the environment and society. Through these methods, designers can maintain a forward-looking perspective and promote innovation and development in New Chinese landscape design.

6. CONCLUSION

In the artificial intelligence era, the construction of narrative systems for New Chinese landscape is not only an inheritance and innovation of Traditional Chinese garden art but also an intelligent enhancement of modern design. This combination not only gives new vitality to traditional culture in the new era but also provides more personalized and interactive experiences through modern technological means, especially the integration of artificial intelligence, offering customized experiences based on user behavior and preferences.

As a carrier for transmitting Chinese history, philosophy, and art, New Chinese landscape guides the public to deeply think about and explore traditional culture. In the context of globalization, the construction of narrative systems for New Chinese landscape helps address the challenges of cultural homogenization, maintain cultural diversity, while shaping urban images with Chinese characteristics and enhancing cities' cultural soft power and international competitiveness.

In the artificial intelligence era, the construction of Chinese discourse and narrative systems for New Chinese landscape is a field full of challenges and opportunities. We earnestly call for more designers and scholars to pay attention to and engage in research and practice in this field, jointly promoting the inheritance and innovative development of Traditional Chinese Culture.

Scholars should conduct in-depth research on Chinese discourse and narrative systems for New Chinese landscape from multiple perspectives including culture, history, philosophy, and art. Through interdisciplinary research, they should explore the deep connotations of Chinese culture and investigate its application methods and forms of expression in modern landscape design. Scholars should also pay attention to the application of artificial intelligence technology in landscape design, studying its impact on landscape narrative content, narrative methods, and narrative experiences.

Furthermore, designers and scholars should strengthen exchange and cooperation to jointly promote theoretical innovation and practical exploration in New Chinese landscape design. Through participation in domestic and international academic conferences, exhibitions, competitions, and other activities, they can share research results, exchange design experiences, and promote the exchange and collision of academic thoughts and practical experiences.

We look forward to designers and scholars actively responding to this call, participating in the research and practice of constructing Chinese discourse and narrative systems for New Chinese landscape in the artificial intelligence era with an open mind, innovative spirit, and practical actions. Let us work together to contribute to promoting the inheritance and innovation of Chinese culture and the diverse development of world garden art.

REFERENCES

- [1] Jin, C. Y. (2016). Exploration of the application of narrative design in New Chinese-style landscape spaces. In *Chinese Architectural Society Proceedings*. Chinese Architectural Society.
- [2] Landscape Materials Network. (2019, April 10). Analysis of New Chinese-style landscape design [Online]. Retrieved December 28, 2024, from https://www.sohu.com/a/307113401_779664
- [3] Li, F. (2023). Application of artificial intelligence technology in modern landscape design. *Engineering Technology Research*, 5(8), 7–9.
- [4] Liu, M., & Hu, J. H. (2021). Application of narrative theory in urban park design. *Industrial Design*, 2021(10).
- [5] Liu, X. (2021). Encountering tradition: An analysis of "New Chinese Style" landscape design techniques. *Modern Horticulture*, 2021(5).
- [6] Liu, Y. (2020). Research on the application of landscape narrative in space. *Modern Horticulture*, 43(13), 2.
- [7] Pan, S., & Jing, X. (2013). Discussion on the characteristics and application of "New Chinese Style" landscape design. *Urban Construction Theory Research*, 2013(23). <https://doi.org/10.3969/j.issn.2095-2104.2013.23.564>

International Journal of Novel Research in Humanity and Social Sciences

Vol. 11, Issue 6, pp: (48-59), Month: November - December 2024, Available at: www.noveltyjournals.com

- [8] Wang, J. (2024). Research on New Chinese-style courtyard design [Master's thesis, Central South University of Forestry and Technology]. *CNKI Database*.
- [9] Wang, R. (2014). Exploration and application of "New Chinese Style" in urban public space landscape design [Master's thesis, Anhui Agricultural University]. *CNKI Database*.
- [10] Yan, X. (2020). Discussion on inheritance and innovation of New Chinese-style landscapes. *Frontiers of Engineering Management*, 6(21).
- [11] Yang, X. (2016). Analysis of the application and methods of "New Chinese Style" in landscape design. *Urban Geography*, 2016(7X), 1. <https://doi.org/10.3969/j.issn.1674-2508.2016.14.217>
- [12] Zhao, D. (2024). Application of narrativity in contemporary urban landscape design [Master's thesis, Southeast University]. *CNKI Database*.